

BHAWANI CONSTRUCTION

DEVELOPER & BUILDER

83A, Cossipore Road, Kolkata - 700 002

Ref. No.

Date

LOCATION MAP AND KEY PLAN WITH LATITUDE AND LONGITUDE FOR THE PROJECT NAMED **BHAWANI APARTMENT** at Holding No. 37/2, G.T. Road, under Ward No. 01 of Bally Municipality, PS - Bally, Dist - Howrah, PIN - 711201, WB, India:

Latitude: 22.59082256402645,

Longitude: 88.3376410345663

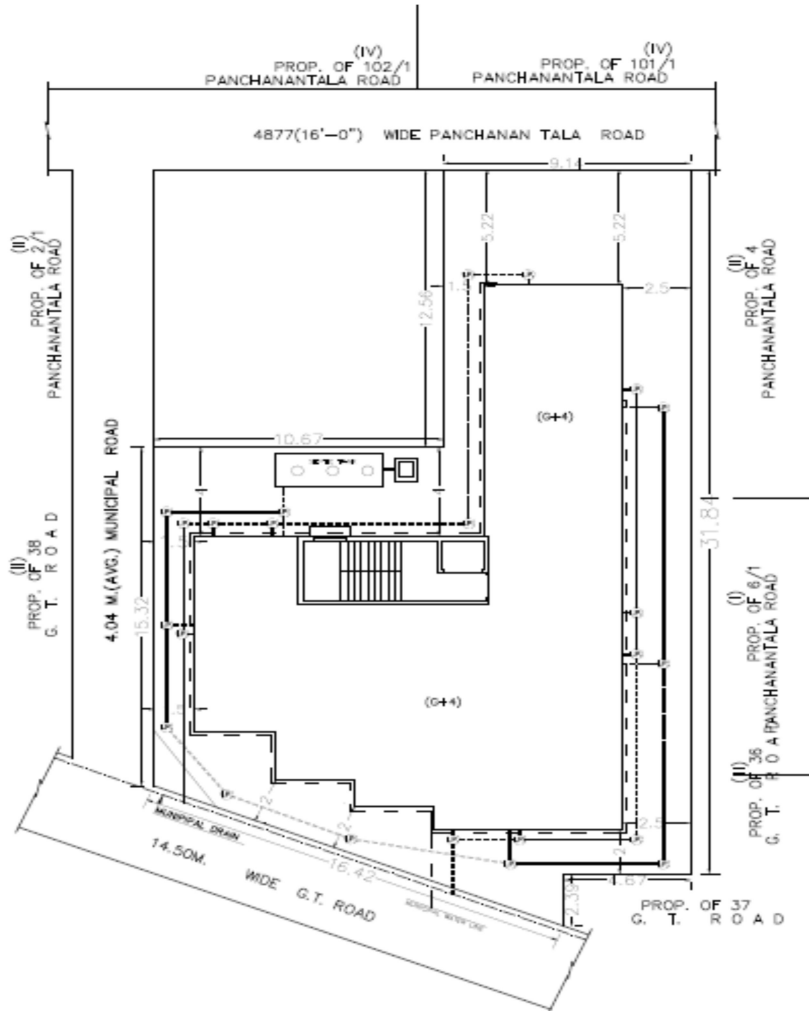

SITE PLAN
SCALE - 1:200

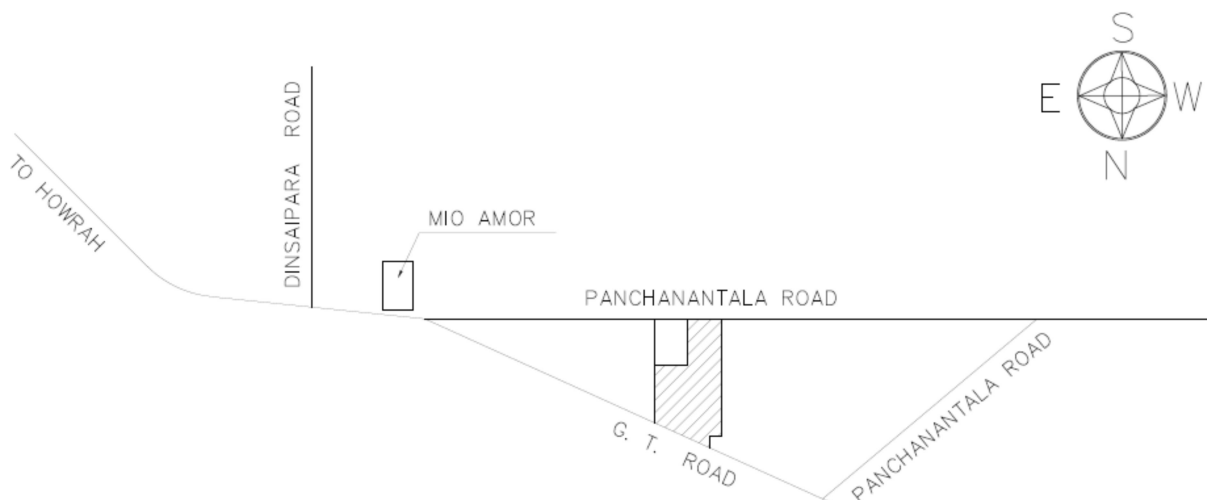

Bhawani Construction

Mamish Sush
Partner